

Dear Sirs

It has recently come to our knowledge that incorrect operation of the filling and pressure equalizing valves pos 13 after filter cleaning has caused some damage to the filter cartridge. In the worst case the loose filter material can cause damage to the bearings.

It is important that the filling and pressure equalizing valves pos 13 are closed after use.

To eliminate the risk of damage to the filter, two nozzles pos 41 can be installed in the thread hole for the pressure equalizing valves as shown in the below drawing.

The nozzles can be ordered at PrimeServ Frederikshavn.
E-mail: Primeserv-frh@mandiesel.com

Yours faithfully

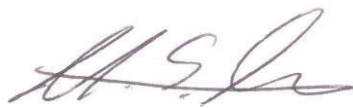

Morten Storm Andersen

Manager
Head of Warranty and Customer Support
PrimeServ Frederikshavn

Action code: **At first opportunity**

Full Flow High Pressure Filters

October 2009
SL09-519/IVL

Concerns

Owners and Operators of MAN
Gear Type AMG / E and EV.

When ordering please state the relevant Plate according to below list.

Gear type	Plate	Pos
AMG11EV	P23525-05	Pos 41
AMG16EV	P23525-05	Pos 41
AMG20EV	P23525-04	Pos 41
AMG28EV	P23525-05	Pos 42
AMG55EV	P23525-01	Pos 41

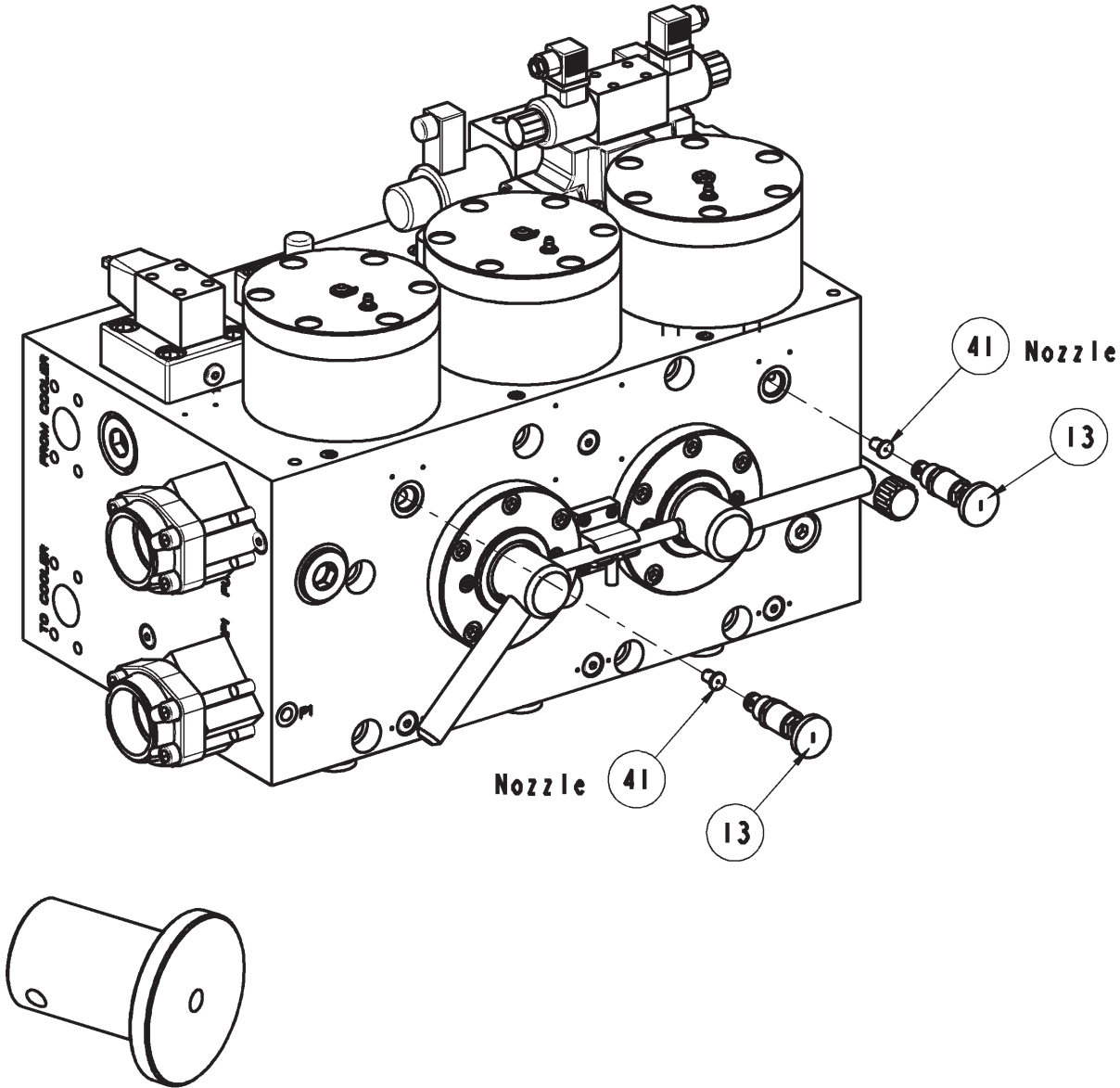



Work card 35 202-01

High pressure filter - check and clean

Safety precautions	Man power	Tools
<ul style="list-style-type: none"> <input type="radio"/> Engine stopped and blocked for start <input type="radio"/> Gearbox stand-by oil pump stopped <input type="radio"/> Propeller shaft locked <input type="radio"/> Select local control 	Working time: ½ hour Capacity: 1 man	No special tools
Data		Replacement and wearing parts
		Plate no: 2 3530

Starting position: Engine and propeller can either be running or be stopped and blocked for start



Procedure

An alarm will occur if the differential pressure on the filter is too high.

1. Turn the change over valve (1) fig 35.3 in position according to the sign on front of valve unit.
2. Make sure that the valve for pressure equalizing (2) between the two filter chambers is closed.
3. Slowly loosen the vent screw (6) at the top of the filter to remove the internal pressure.

Fig 35.3

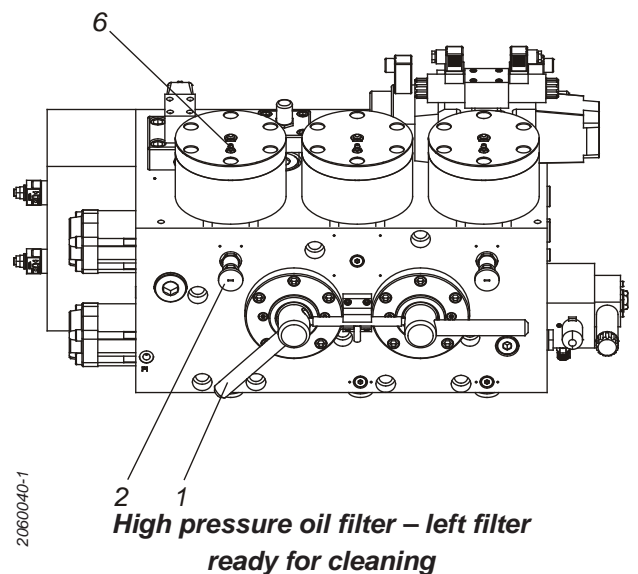

2004-08-20

Fig 35.4

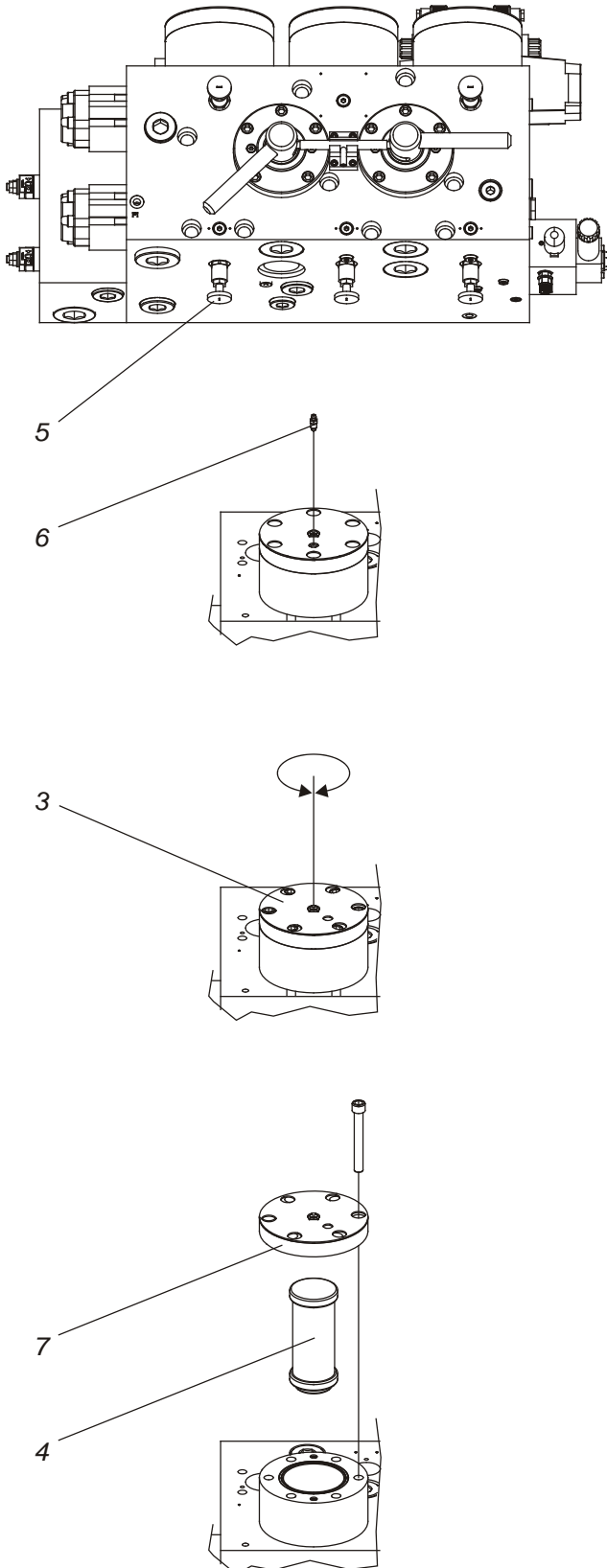

4. Loosen the drain valve (5) fig 35.4 at the bottom of the valve unit to drain the oil from filter to gearbox.
5. Remove the venting screw (6) and turn the safety plate (3).
6. Remove the top cover (7).
7. Remove the filter element (4) from the filter housing.
8. Clean the filter element in gas oil.
9. After cleaning of the filter element, the filter must be inspected for damage in the surface. If any damage is observed, the filter element must be replaced with a new one.
10. Put back the filter into the filter housing.
11. Fit the top cover and safety lock.
12. Tighten the venting screw. One at the top and the drain valve at the bottom.
13. Open the valve (2) fig 35.3 for pressure equalizing between the two filter chambers.
14. Turn the change over valve back to middle position so all filter elements are in operation again.
15. Close valve (2).